



AUCTION

WEDNESDAY, OCTOBER 22 • 6 PM

New Haven / Hoagland Area Country Home
6528 Minnich Road *(Located 1 1/2 miles south of New Haven)*

2 Bedroom / 2 Bath on Basement!

HOME FEATURES:

- Hardwood Flooring throughout
- Large Kitchen plus Dining area
- Large Living Room
- Large Master Bedroom with bath
- 3/4 Basement, finished
- Newer Windows and Siding, New Roof
- Newer 5" Well
- Updated 200 amp electric
- 2 Car finished garage

Annual Taxes: 436.38 with exemptions

**OPEN HOUSE
TO PREVIEW THE
REAL ESTATE:**
SUNDAY, OCTOBER 5,
**1-3PM, or call office for
private showing**

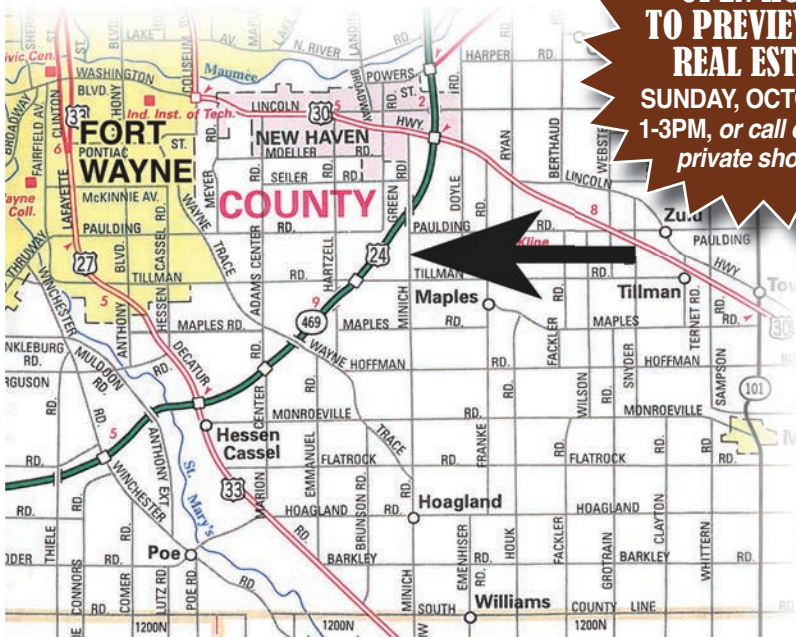

SELLER: VIOLA BEARMAN

AUCTIONEERS:
JERRY EHLE
MIKE ROY

SCHRADER
REAL ESTATE & AUCTION
of Fort Wayne, LLC

260-749-0445 • 866-340-0445
www.SchraderFortWayne.com



Residential Client Full Detail Report

Listings as of 09/30/2014

Page 1 of 1

| | | | | | | | | | |
|---|-------------------|---|--------------|--------------------------|---------------|-----------|-----------------|-----------|---|
| Property Type | RESIDENTIAL | Status | Active | Auction | Yes | | | | |
| MLS # | 201442127 | 6528 Minnich Road | New Haven | IN 46774 | Status Active | LP \$0 | | | |
|  | Area | Allen County | Parcel ID | 02-13-25-276-007.000-039 | | Type | Site-Built Home | | |
| | Sub | None | Cross Street | Bedrms | 2 | F Baths | 2 | H Baths | 0 |
| | Location | Rural | Style | One Story | | | | | |
| | School District | EAC | Elem | New Haven Intermediate | JrH | New Haven | SrH | New Haven | |
| | Legal Description | E 1/2 SE 1/4 NE 1/4 EX N | | | | | | | |
| | Directions | Minnich Road south of New Haven over I-469 and just before the RR tracks. | | | | | | | |

Remarks Auction Date is Oct. 22 at 6:00 on site

| | | | | | | | | | | | | |
|-----------------|---------|--------------------|---|--|-------------------|---------|--------------------|----------------------------------|--|-----------------|------------------|------|
| Sec | Lot | Zoning | Lot Ac/SF/Dim | | | | 0.6500 / 28,314 | oxo | Src N | Lot Des | Partially Wooded | |
| Township | Adams | | Abv Gd Fin SqFt | 1,508 | Below Gd Fin SqFt | 844 | Ttl Bel/pw Gd SqFt | 1,144 | Ttl Fin SqFt | 2,352 | Year Built | 1952 |
| Age | 62 | New/Not Applicable | Date Complete | | Ext | Vinyl | Fndtn | Partially Finished | | | # Rooms | 7 |
| Room Dimensions | | | | | | | | | | | | |
| | DIM | L | | | | | | | | | | |
| LR | 25 x 13 | M | Baths | Full | Half | Water | WELL | Dryer Hookup Gas | No | Fireplace | No | |
| DR | x | | B-Main | 2 | 0 | Sewer | Septic | Dryer Hookup Elec | Yes | Guest Qtrs | No | |
| FR | x | | B-Upper | 0 | 0 | Fuel / | Oil, Forced Air | Dryer Hook Up Gas/Elec | No | Split Firpln | No | |
| KT | 14 x 11 | M | B-Blw G | 0 | 0 | Heating | | Disposal | No | Ceiling Fan | Yes | |
| BK | 11 x 11 | M | | | | Cooling | None | Water Soft-Owned | No | Skylight | No | |
| DN | x | | Laundry Rm | Main | 7 | x 8 | | Water Soft-Rented | No | ADA Features | No | |
| MB | 19 x 15 | M | AMENITIES | Breakfast Bar, Ceiling Fan(s), Countertops | | | | Alarm Sys-Sec | No | Fence | | |
| 2B | 11 x 11 | M | -Laminate, Dryer Hook Up Electric, Eat-In Kitchen, Foyer Entry, | | | | | Alarm Sys-Rent | No | Golf Course | No | |
| 3B | x | | Garage Door Opener, Landscaped, Patio Open, Porch Open, | | | | | Jet/Grdn Tub | No | Nr Wlkg Trails | No | |
| 4B | x | | Garage | 2.0 | / Attached | / | 24 x 24 / 576.00 | Pool | No | Garage Y/N | Yes | |
| 5B | x | | Outbuilding | None | | x | | Pool Type | | Garage Dr Opnr: | Yes | |
| RR | 44 x 19 | L | Outbuilding | | | x | | Off Street Pk | Yes | | | |
| LF | x | | Assn Dues | Not Applicable | | | | SALE INCLUDES | Refrigerator, Washer, Window Treatments, Range | | | |
| EX | x | | Other Fees | | | | | -Electric, Water Heater Electric | | | | |
| WtrType | | | Restrictions | | | | | | | | | |
| Water Features | | | Water Access | | Wtr Name | | | | | | | |
| | | | Wtr Frtg | | Channel Frtg | | | | | | | |

Virtual Tours:

| | | | | | | | | |
|------------------------|--|---|--|-----------------------------|--------------------|---------------------|---------------------------|------|
| Auction | Yes | Auction Reserve Price \$ | | Auction Date | 10/22/2014 | Auction Time | 6:00 | |
| Auctioneer Name | Jerry Ehle | | | Auctioneer License # | AU19300123 | | | |
| Financing: | Proposed | Cash, Conventional | | Exemptions | Homestead, Over 65 | | Year Taxes Payable | 2014 |
| Annual Taxes | \$436.38 | Is Owner/Seller a Real Estate Licensee | | No | Possession | | DOC | |
| List Office | Schrader Real Estate & Auction - Offc.: (260) 749-0445 | | | | | | | |

Yes

| | | | | | | | | | |
|-----------------------------|--|---------------------|--|----------------------|--|-----------------|--|-------------|---|
| Pending Date | | Closing Date | | Selling Price | | How Sold | | CDOM | 8 |
| Ttl Concessions Paid | | | | | | | | | |

Presented by: Jerry Ehle - Cell: (260) 410-1996

/ Schrader Real Estate & Auction - Offc.: (260) 749-0445

Information is deemed reliable but not guaranteed.

MLS content is Copyright © 2014 Indiana Regional Multiple Listing Service LLC

Featured properties may not be listed by the office/agent presenting this brochure.

REAL ESTATE AUCTION TERMS AND CONDITIONS

PROCEDURE: The property will be offered at oral auction.

DOWN PAYMENT: \$2000 down payment on the day of auction with the balance in cash at closing. The down payment may be made in the form of cash, cashier's check, personal check or corporate check. Your bidding is not conditional upon financing, so be sure you have arranged financing, if needed, and are capable of paying cash at closing.

ACCEPTANCE OF BID PRICES: The successful bidder will be required to enter into a purchase agreement at the auction site immediately following the close of the auction. The final bid is subject to the Seller's acceptance or rejection.

EVIDENCE OF TITLE: Seller shall provide

an owner's title insurance policy in the amount of the purchase price.

DEED: Seller shall provide a Personal Representative's Deed.

CLOSING: The balance of the purchase price is due at closing, which will take place within 30 days of presentation of insurable title. Costs for an insured closing shall be shared 50:50 between Buyer(s) and Seller.

POSSESSION: Possession day of closing, immediately following the closing.

REAL ESTATE TAXES: Real Estate Taxes will be pro-rated to the day of closing.

SURVEY: A new perimeter survey will be completed only if necessary for Title Commitment. The seller shall determine any need for a new survey and shall order survey. The

cost of the new survey, if necessary, shall be split 50/50 between Buyer and Seller.

AGENCY: Schrader Real Estate & Auction Co. and its representatives are exclusive agents of the Seller.

DISCLAIMER AND ABSENCE OF WARRANTIES: All information contained in this brochure and all related materials are subject to the terms and conditions outlined in the Purchase Agreement. The property is being sold on "AS IS, WHERE IS" basis, and no warranty or representation, either express, or implied, concerning the property is made by the Seller or the Auction Company. All sketches and dimensions in the brochure are approximate. Each potential bidder is responsible for conduct of his or her own inde-

pendent inspections, investigations, inquiries, and due diligence concerning the property.

The information contained in the brochure is subject to verifications by all parties relying on it. The Seller or the Auction Company assumes no liability for its accuracy, errors, or omissions. Conduct of the auction and increments of bidding are at the discretion of the Auctioneer. The Seller and Selling Agents reserve the right to preclude any person from bidding if there is any question as to the person's credentials, fitness, etc. All decisions of the Auctioneer are final.

ANY ANNOUNCEMENTS MADE THE DAY OF THE SALE TAKE PRECEDENCE OVER PRINTED MATERIAL OR ANY OTHER ORAL STATEMENTS MADE.