

FARM EQUIPMENT AUCTION

Southern MI • Northwest of Coldwater, MI
505 South Railroad St, Union City, MI

Monday, September 16 • 10am

September	Su	M	Tu	W	Th	F	Sa
	1	2	3	4	5	6	7
	8	9	10	11	12	13	14
	15	16	17	18	19	20	21
	22	23	24	25	26	27	28
	29	30					

Auction Managers:

Ed Boyer • 574.215.7653 • ed@boyerpig.net
& Ted Boyer • 574.215.8100
#6505261770, #6501225192

Get Our iOS App: Follow Us On: YouTube

TERMS: Cash or Check, 3% on Credit Card. Announcements made the day of the auction take precedence over any printed material, & oral statements made. Lunch Available. Not Responsible for Accidents.

SCHRADER LIVE INTERNET BIDDING
Real Estate and Auction Company, Inc. Visit SchraderAuction.com for Details or call 800-451-2709

800.451.2709
www.SchraderAuction.com



Corporate Headquarters:
950 N Liberty Dr, PO Box 508
Columbia City, IN 46725



FARM EQUIPMENT AUCTION

Southern MI • Northwest of Coldwater, MI
505 South Railroad St, Union City, MI

- Harvest Equipment
- Tractors • UTV
- Tillage • Trucks
- Trailers • Planting
- Crop Care
- Hay & Misc. Equipment



Monday, September 16 • 10am

SCHRADER
Real Estate and Auction Company, Inc.

800.451.2709
www.SchraderAuction.com

LIVE INTERNET BIDDING
Visit SchraderAuction.com for Details or call 800-451-2709

FARM EQUIPMENT AUCTION

Southern MI • Northwest of Coldwater, MI
505 South Railroad St, Union City, MI

- Harvest Equipment
- Tractors
- UTV
- Tillage
- Trucks
- Trailers
- Planting
- Crop Care
- Hay & Misc. Equipment



Monday, September 16 • 10am

SCHRADER
Real Estate and Auction Company, Inc.

800.451.2709
www.SchraderAuction.com

LIVE INTERNET BIDDING
Visit SchraderAuction.com for Details or call 800-451-2709

FARM EQUIPMENT AUCTION

Southern MI • Northwest of Coldwater, MI
505 South Railroad St, Union City, MI

No Smalls! Be on time! Very Nice,
Well-Maintained Line of Equipment!

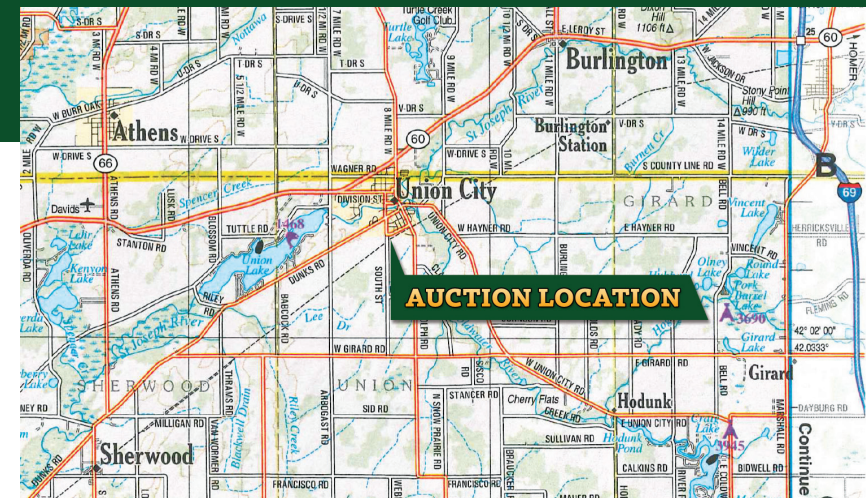

Auction Location: 505 South Railroad St, Union City, MI
Directions: M60 to Union City go south on Broadway St. through town to Railroad St. (south edge of town) goes West to Auction Site. (intersection of Railroad St. & South St.)



HARVEST EQUIPMENT

- **JD HD45F Draper Flex Head**, 45', Hyd. Assist Gauge Wheels, X9 Hookup can be converted to smaller combine, S# 1HOHD45FJP0825508
- **Unverferth Head Cart**, 48', AWS, 4 Wheel Steer, Brakes, Light Kit
- **JD C12F Folding Corn Head**, 12x30" Row Max Chopping Rolls, Stalk Stompers, Header Height & Row Sensors, 1HOC12FXOP085752
- **J&M X1522 Track Grain Cart**, 36" Tracks, X-Tended Reach Auger, I Farm Scales, Camera System, Roll Tarp, Lights, S# 2210752
- **2024 Loftness XLB 10 Grain Bagger**, 10', Semi Loadout System w/ Hyd. Swing Auger, Electric Crane & Trolley System, Remote Control, XL Hopper, Transport Wheels, also has Reg. Hitch, XBA10D S# 68-394
- **2024 Loftness GBU 10 Grain Bagger**, Hyd. Tilt Spout, Bag Baler, S# 51-1673
- **11- HITEC Grain Bags**, New, 15,000 Bu., 10'X300'
- **Harvest International T1332 Loadout Transport Auger**, 13"x32', PTO, S# 06152

TRACTORS & UTV

- **2015 CASE IH 620 Quad Trac**, AFS, Beacon RTK, 36" Tracks w/ 150 Hrs. on Tracks, Leather Seat, 6 Remotes, PTO, 3411 Hrs. S# 620ZEF303048
- **CASE IH 315 Magnum**, MFWD, AFS, Beacon RTK, 480/80R50 Duals, 380/80R38 Fr. 4 Remote w/ Power Beyond, 3 Pt. w/ Coupler, Big 1000 Pto. 15 SC Wts. 4 Rear Wts. 5836 Hrs. S# ZDRD09461
- **IH 1086**, Cab, 18.4X38, 3 Pt. 2 Remote, 540 / 1000, Wt. Bracket, S# 261077 U029823
- **CASE IH Duals**, MFWD 380/80R38
- **2021 INTIMIDATOR GCIK UTV**, Bad Dawg, Cab, Electric Dump, 178 mi.

TILLAGE

- **Sunflower 4233 Disk Chisel**, 23 Shank, C-Flex Cushion, 8 Wheel Walking Beam, Hyd. Fold, Light Kit, S# 4233J08037
- **Glencoe SS 7400 Soil Saver Disk Chisel**, 17 Shank, Cushion Gang, 6 Wheel Walking Beam, S# 7400LNSS104
- **Sunflower 4412 Disk Ripper**, 7 Shank, Cushion Gang, Walking Beam, 3 Row HD Spring Tine Att. S# AGCS44120AZ400021*07
- **2018 Degelman 40 Pro Till**, 40' 4 Lift Axles, Rubber Rollers, S# PTL3255
- **2022 Norwood HSD 3500 Quick Till**, 35' 4 Axle Super Float Tires, S# D6247
- **2022 RJ Equipment 40' Roller**, 36" Rollers, Hyd. Fold, S# 22071
- **Unverferth Perfecta 14'**, 3 Pt, Danih Tine, Spray Boom, Rear Hitch

TRUCKS & TRAILERS

- **1988 Cobra Frameless Alum. Dump Trailer**, 39' Spread Axle. Air Ride Front dump Axle, 24.5 Low Pro Alum. Wheels, Grain Door, Roll Tarp
- **2001 Lode King Train**, Steel Trailers, 6 Axles 11R22.5, 2 Air Lift Axles, Electric Sioux City Tarps 1 year old
- **2017 Freightliner Columbia Glider Semi #25**, Day Cab, HK14 Detroit Non-Emissions, 13 Sp. NEW, 295/75R22.5, Air Ride, Alum. Wheels, Truck 123839 mi., Engine 334974 mi.,
- **2007 Freightliner Columbia Semi #22**, Day Cab, 14L Detroit 10 Sp. 295/75R22.5, Air Ride, Wet Kit, 632200 mi.

PLANTING & CROP CARE

- **2017 CASE IH 1255 24x30" Planter**, Harvest International Laser High Speed Units New in 2024, Bulk Fill, 2x2 Infurrow Surefire Hyd. Drive, 400 gal. Air Adj. Floating Row Cleaners, Side Closing Wheels, Electric Drive, Delta Force, Red Ball, Markers
- **Demco Saddle Tanks**, 1000 gal. Poly, Side Quest Axle Mount, Brackets for Large Frame Magnum
- **Demco Nose Mount Tank**, 300 gal. Poly, 20" Frame Mount
- **2014 JD 4940 Sprayer**, 1200 gal. SS Tank, 120' Boom 15" Spacing, Auto Sec. 11 Sec. New Pump, Auto Steer & Leveling, VF380/65R50 Tires, Up Dated Hubs, NO GPS Equip, 4544 Hrs.
- **2014 New Leader 30/30 SS Dry Box**, Multi Box Control, W/ JD Running Gear for Storage
- **1 Pair 380/65R50 Direct Duals**, w/ Spacers for JD4940 Sprayer
- **2007 Great Dane 48' Trailer**, Tri. Axle, Air Ride Tandem w/ Third Air Lift, 2- 2600 gal. Poly Tanks, Transfer Pump, Inductor, 3" Lines
- **10,000 gal. Poly Tank**, Vertical, Valve
- **JD 7000 Planter**, 6x30", No-Till, Dry Fert. Insect Att. Seed Firmers, Monitor
- **JD 8300 Grain Drill**, Grass Seed Att. 24x6", Single Disk, 20" Wheels, JD Black Cyl.

HAY & MISC. EQUIPMENT

- **CASE IH 8340 Round Baler**, 4x4 Bale, Twine, All New Belts, Hyd. Tie
- **Kubota DMC8028R Disk Bine**, Rubber Rolls
- **Kubota RA1042 Rake**, Single Wheel
- **Haybuster 256 plus II**, Bale Buster
- **GEHL 1410 Manure Spreader**, Poly Floor, Dual Beater, Hyd. Gate, 22.5 Tandem
- **15,000 gal. Fuel Tank**, Double Wall, w/3 Phase Pump
- **Inter Systems Leg**, approx. 45', 5,000 Bu. 7.5 3 Phase Motor



Inspection Dates: Fri, Sep. 13 from 10am-2pm
& Sat, Sep. 14 from 10am-2pm



Monday, September 16 • 10am